

Rabo PinBox Vast (VEGA3000)

Gebruikershandleiding

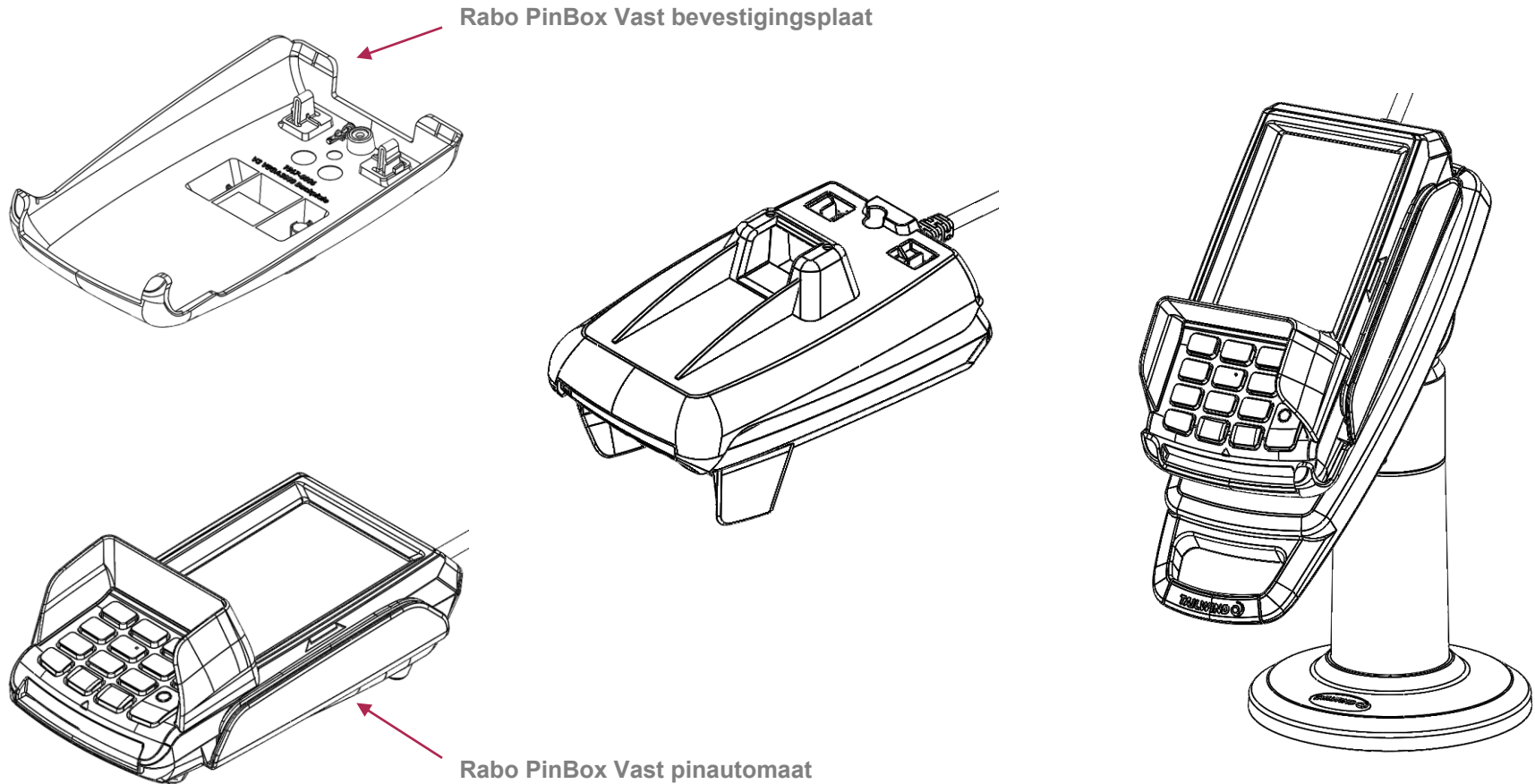

Rabo PinBox Vast bevestigingsplaat

Installatiehandleiding

Gereedschap

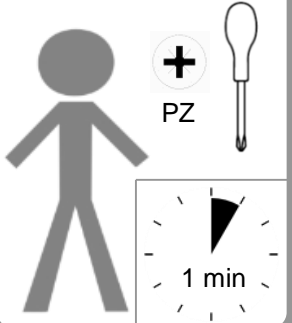

Onderdelen

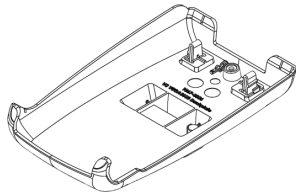

1x VEGA3000 Backplate
1x M2x10mm Screw

1

Verwijder kabelklepje en schroefje, bewaar veilig

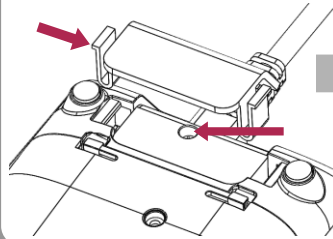

2

Schuif de automaat in de bevestigingsplaat zoals hierin zichtbaar

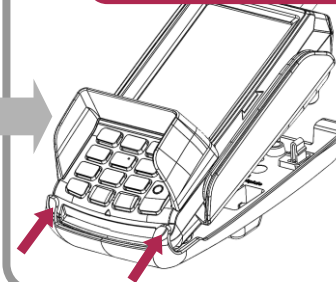

3

Draai de automaat in de bevestigingsplaat

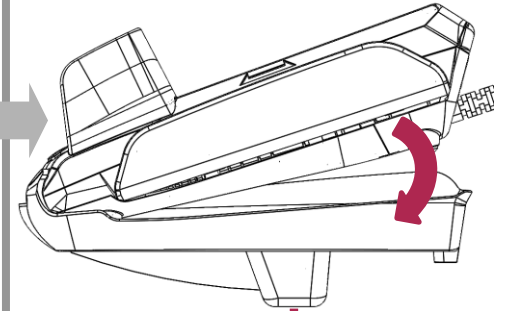

6

Klik de automaat in de standaard

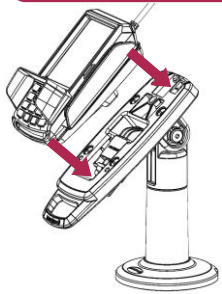

5

Plaats bijgeleverde schroef

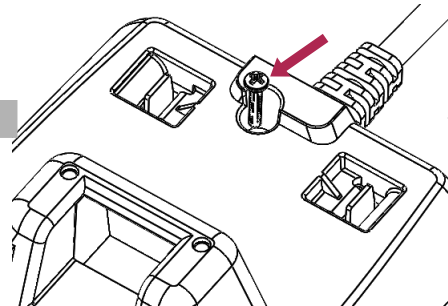

4

Druk stevig totdat u twee klikjes hoort

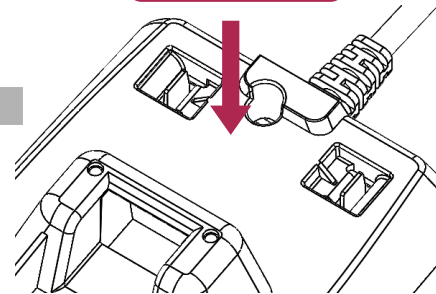

Bevestigingsplaat verwijderen:
Draai schroef los en beweeg de clipjes naar elkaar toe

